

# GENERAL SPECIFICATION OF HS-70MG HIGH TORQUE METAL FEATHER SERVO

## 1. TECHNICAL VALUE

CONTROL SYSTEM	: +PULSE WIDTH CONTROL 1500usec NEUTRAL	
OPERATING VOLTAGE RANGE	: 4.8V TO 6.0V	
OPERATING TEMPERATURE RANGE	: -20°C TO +60°C (-4°F TO +140°F)	
TEST VOLTAGE	: AT 4.8V	AT 6.0V/REFERENCE USE ONLY
OPERATING SPEED	: 0.17sec/60° AT NO LOAD	0.14sec/60° AT NO LOAD
STALL TORQUE	: 2.4kg.cm(33.51oz.in)	3.0kg.cm(41.89oz.in)
STANDING TORQUE	: -	
IDLE CURRENT	: 8mA AT STOPPED	8mA AT STOPPED
RUNNING CURRENT	: 140mA/60° AT NO LOAD	160mA/60° AT NO LOAD
STALL CURRENT	: 960mA	1250mA
DEAD BAND WIDTH	: 5usec	5usec
OPERATING TRAVEL	: 40°/ONE SIDE PULSE TRAVELING 400usec	
DIRECTION	: CLOCK WISE/PULSE TRAVELING 1500 TO 1900usec	
MOTOR TYPE	: CORED METAL BRUSH/Nd MAGENT	
POTENTIOMETER TYPE	: 2 SLIDER/DIRECT DRIVE	
AMPLIFIER TYPE	: ANALOG S.M.T	
DIMENSIONS	: 23.6x11.6x29mm(0.92x0.45x1.14in)	
WEIGHT	: 12.7g(0.44oz)	
BALL BEARING	: SINGLE/MR85	
GEAR MATERIAL	: 1 RESIN & 4 METAL GEARS	
HORN GEAR SPLINE	: 25 SEGMENTS/ø5	
SPLINED HORNS	: MICRO23: M23-I, M23-X	
CONNECTOR WIRE LENGTH	: 160mm(6.29in)	
CONNECTOR WIRE STRAND COUNTER	: 20 EA	
CONNECTOR WIRE GAUGE	: 28AWG	

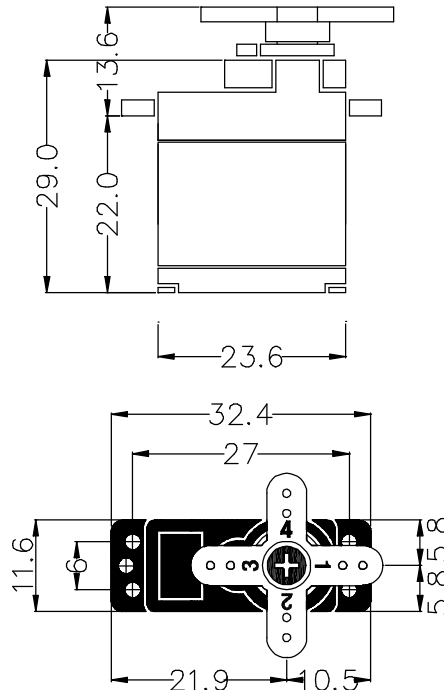

## 2. FEATURES

4 METAL GEARS WITH 1 BALL BEARING  
HIGH EFFICIENCY Nd MAGNET MOTOR

## 3. APPLICATIONS

FAST PARK FLYING MODELS. ELECTRIC MICRO PLANE, MAV  
1/18 SCALE CARS